

HOGUE DUTY HOLSTER

USAGE INSTRUCTIONS



HOGUE®

HOGUE, INC.
P.O. BOX 91360
HENDERSON, NV 89009
800-438-4747

Hogueinc.com

CRD_INS_DUTY_03142017

Hogue Holster User Guide

Read and understand all owner's manuals and instructions provided by the manufacturer of your handgun prior to holster usage.

- Improper or careless use of a firearm and/or holster may result in serious injury or death. It is the user's responsibility to have a thorough knowledge of all aspects of firearm and holster safety and use.
- Your holster has been preadjusted to fit your firearm but end-user fine adjustment is recommended (see tension adjustment section.) **Test the holster for proper fit with your firearm in an unloaded condition.** Once fit has been determined we recommend tightening with a thread lock compound.
- If your firearm is equipped with a safety lever, be sure the safety is engaged when holstering the firearm.
- When drawing firearm from holster or replacing it in holster do not place finger near the trigger. Position trigger finger adjacent to but away from the trigger.
- While obtaining a shooting grip with trigger finger extended straight, press the lever release down with thumb to release hood and stock. Hood can also be released manually by pushing it forward. Draw firearm straight up. When re-holstering firearm, insert straight down until audible "click" is heard.
- It is the user's responsibility to properly maintain holster regularly including checking screws and lever for proper function.

- Do not expose the holster to extreme heat conditions.
- Never store your holster near a heat source. Avoid storing holster near space heaters, radiators, fireplaces or other heating sources that may emit high temperatures. Temperatures in excess of 200° may deform or damage the polymer from which Hogue Holsters are made.
- Do not leave holster in trunk of vehicle during extremely hot weather.



Maintenance

The holster requires minimal maintenance dependent upon level of usage. It is the user's responsibility to inspect the holster for signs of excessive wear, or loss of retention of the handgun, and to tighten all screws and hardware. We recommend a thread lock compound once you have determined your holster mounting and tension preferences.

If the holster begins to feel sticky, use a lubricant or silicon spray at the rotating hood pivot [1], on the handle lever pivot [2], and onto the retention mechanism [3].



Adjustments

Standard Jackbar Set-up

Your holster has been assembled with the following parts to fit 2" and 1-3/4" belts. Unscrew screws to tighten jackbar to belt.

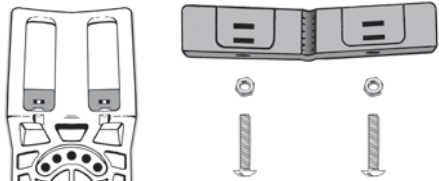

Use the standard jackbar (factory installed)
Use two 6-32 x 1/4 nuts (factory installed)
Use two 6-32 x 5/8 long screws (factory installed)

Short Jackbar Set-up

Use the following supplied pieces from the parts kit to adjust to fit 2-1/4" belts. Unscrew screws to tighten jackbar to belt.

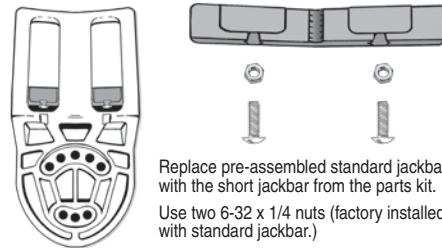

Replace pre-assembled standard jackbar with the short jackbar from the parts kit.
Use two 6-32 x 1/4 nuts (factory installed with standard jackbar.)
Use two 6-32 x 3/8 short screws from the parts kit.

Combo Jackbar Set-up

Use the following supplied pieces from the parts kit to adjust to fit 1-1/2" belts. Unscrew screws to tighten jackbar to belt.

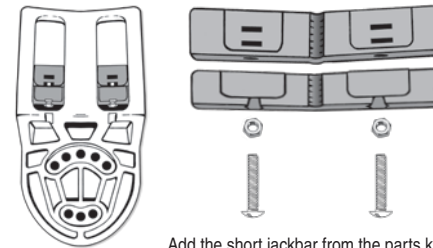

Add the short jackbar from the parts kit beneath the standard jackbar.
Use two 6-32 x 1/4 nuts (installed on standard jackbar.)
Use two 6-32 x 5/8 short screws (installed on standard jackbar.)

Holster Tension

Using supplied hex wrench, turn tension screw located on the inside of the holster clockwise to tighten or counter clockwise to relieve tension on the firearm. Tension should be set to eliminate any movement in the muzzle area. Do not over-tighten as it may affect the smooth draw ability.



MOLLE MOUNT ADAPTER ASSEMBLY INSTRUCTIONS

- Replace belt plate with the MOLLE Mount Adapter by removing 3 screws.
- Use angled screw holes to vary the mounting angle to desired position.
- Use standard MOLLE weave to fasten holster to any standard MOLLE mount compatible unit.

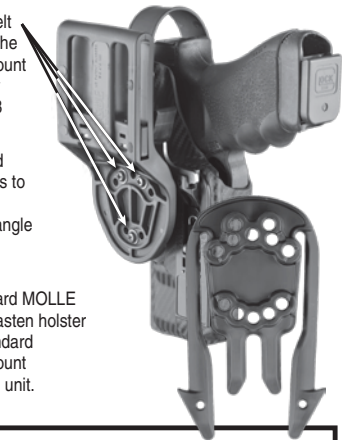

Your Hogue Holster should only be used with the specific firearm for which it was designed. All firearms are potentially dangerous; their handling and use may cause property damage, serious personal injury or death. It is your responsibility to safely store, transport, handle, operate and use your firearm. Proper training is available through accredited firearm safety programs.