

## USE INSTRUCTIONS FOR The HOGUE® BLACK GUN WRENCH

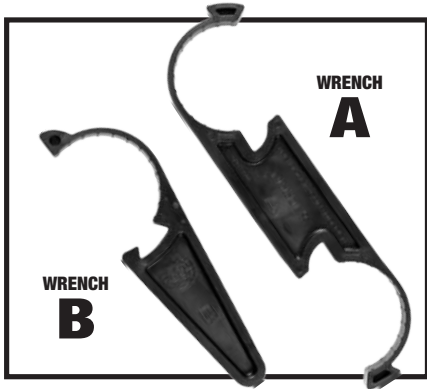

**1.** The Hogue Black Gun Wrench is made out of an extremely strong and durable polymer. The plastic will not break under normal use. Required safety equipment consists of safety glasses and a set of work gloves.

The complete wrench is comprised of two parts labeled **wrench A** and **wrench B**. The wrench fits two different dimensions: 2" diameter for the barrel nut and 2-1/8" diameter for the extension jam nut. There are directional arrows molded onto the surface labeling which direction the wrench should be turned.



**2.** To install the barrel nut first remove the charging handle and bolt carrier group from the upper receiver. Second, remove the gas block and the gas tube. Third, clamp the upper receiver into a vise using an upper receiver vise block and remove the existing barrel nut. It is important to **Lubricate** the threads and bearing face of the Hogue barrel nut and the flange face of the barrel extension with assembly lube.

Next, hand tighten the nut onto the receiver and inspect the gas tube hole alignment. One hole in the barrel nut must be aligned with the hole (1) in the upper receiver for the gas tube to pass through. If 1/4 or more of the upper receiver hole (1) is exposed through the barrel nut hole (2) it is recommended that you bypass that hole and rotate the nut to the next one (3). This will properly torque the nut within the desired specification of 35-85 ft lbs.

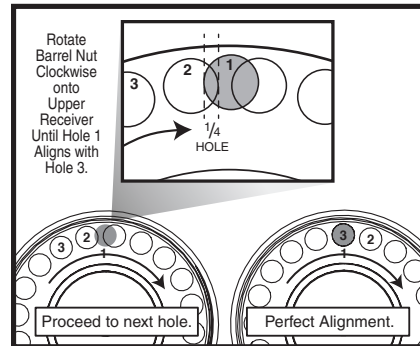

**3.** To attach the wrench to the barrel nut, insert the arm of the 2 inch side of **wrench A** into the center opening of **wrench B**. Leave the arm of **wrench A** resting outside and below the opening of **wrench B**.

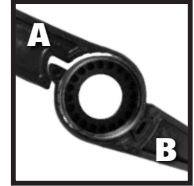

Slide the tool over the barrel nut knurling observing the directions of the arrows on the tool. Lever the opening of **wrench A** over the arm of **wrench B** making sure that both parts of the tool are properly aligned. This is purposely made tight so that the wrench has maximum hold onto the barrel nut. To rotate the nut, first apply force to **wrench A**, then also apply force to **wrench B**. As you tighten the nut, constantly check the gas tube hole alignment. If the nut will not tighten any further, loosen then tighten the nut a few times before the final hole alignment. **If you bypass a hole you must proceed to the next one for proper torque.**

**4.** To remove a Hogue barrel nut, reverse the direction of the tool. For the extension lock nut, use the tool in the same manner using the 2-1/8" side.

### Troubleshooting

If the tool slips on the knurling, get a piece of emery cloth and place it between the tool and the barrel nut **with the abrasive side facing the wrench.**